

Planning Permit No.
APPROVED
Subject to the conditions in
this office letter.
No. A/11035/89 dt. 25-9-89
G. Vignaneswari
FOR MEMBER SECRETARY
MADRAS METROPOLITAN
DEVELOPMENT AUTHORITY

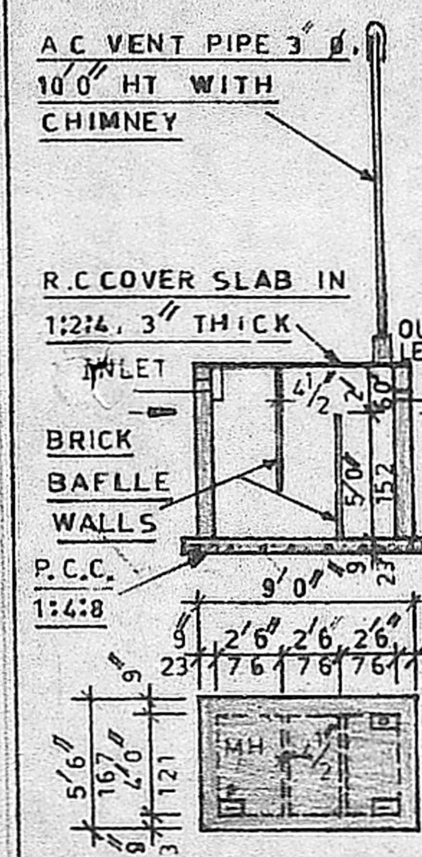
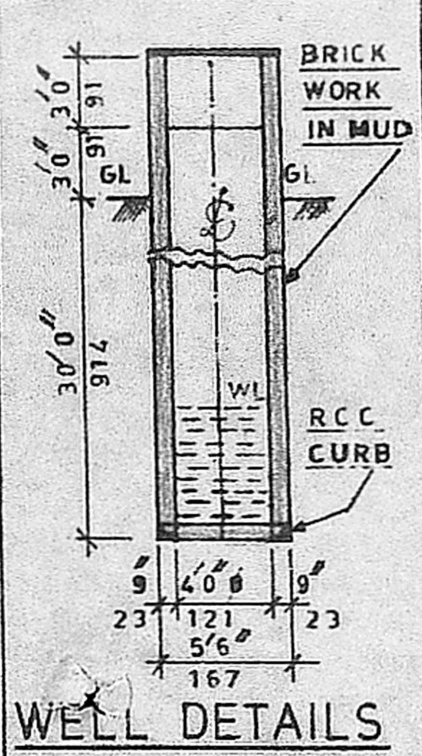

SPECIFICATION

EARTH WORK: ALL EARTH WORK EXCAVATION IN FOUNDATION TO BE DONE AS PER THE DIMENSIONS GIVEN IN THE SECTIONAL DRAWING

SAND FILLING: ALL FOUNDATIONS TO BE FILLED UP WITH RIVER SAND UP TO 150mm THICK.

P.C. CONCRETE: ALL FOUNDATIONS TO BE FILLED UP WITH P.C.C. 1:4:8, 300mm THICK AND SHOULD BE WELL RAMMED.

MASONRY WORK: ALL MASONRY WORKS SHOULD BE IN FIRST CLASS BURNT BRICKS WITH CM 1:5.

R.C.C. WORKS: ALL R.C.C. WORKS SUCH AS PLINTH, BEAMS, LINTALS, SUNSHADES, LOFTS, ROOF SLAB AND COLUMNS ETC., SHOULD BE IN A RATIO OF 1:2:4 USING 19mm FINE AGGREGATE & SUITABLE TOR STEEL RODS.

PLASTERING: ALL INTERIOR AND EXTERIOR PLASTERINGS ARE IN C.M. 1:4 12.5mm THICK.

FLOORING: ALL FLOORINGS ARE IN P.C.C. 1:4:8/SURKI CONCRETE 1:2:5 100mm THICK AND SHOULD BE FINISHED WITH CEMENT PAVEMENT 1:3 20mm THICK/MOSAIC TILES FLOORING

WEATHETING COURSE: WEATHETING COURSE SHOULD BE AS PER M.D.S.S. AND SHOULD BE PROVIDED OVER OPEN ROOF SLAB

SCHEDULE OF JOINERIES

D=C.W. DOOR PANELLED TYPE- 3'3"x6'6" (100x198)	
D1=C.W. DOOR PANELLED TYPE: 2'6"x6'0" (76x182)	
W= C.W. WINDOW	5'0"x4'0" (152x121)
W1= C.W. WINDOW	3'0"x4'0" (091x121)
V= C.W. VENTILATOR	3'0"x2'0" (091x061)
C= R.C. CUP-BOARD	3'3"x6'6" (100x198)

PLOT AREA 1200 SF.T. (111.48 M²)
PLINTH AREA 440 SF.T. (40.88 M²)

PLAN OF A PROPOSED DWELLING HOUSE IN PLOT No 46 Part, S.No 250/1 AT MANGALA NAGAR LAY OUT OF V.No 98, PORUR VILLAGE, SAIDAPET TALUK, CHENGALPATTU DIST. FOR Smt. S. RAJESWARI.
SCALE: 1"=8'0"

DESIGNED & DRAWN BY
NOORI PLANNERS,
Plot No. 34, Mosque St., Jaya Nagar,
Porur P.O. Madras - 600 116.
NP 2789
S. Rajeswari
OWNER

R. Mohan Rao
R. MOHAN RAO, D.C.E.
LICENSED SURVEYOR.
ALANDUR MUNICIPALITY.
AMBATTUR TOWNSHIP.
BRANCH OFFICE.
NOORI PLANNERS,
PLOT NO. 34, MOSQUE ST. E.T.,
JAYA NAGAR, POPUR, P.O.
LICENSED SURVEYOR